

# VerSus International Student Competition

# 1

## Poster 1: Analysis and Concepts

Authors: Alejandro García Pedrón, Raquel Sola Rubio

### CONTEMPORARY RURAL SETTLEMENT IN LOS PEDRONES (VALENCIA)

#### CULTURAL LANDSCAPE >

Pictures from the project site. Los Pedrones, Requena (Valencia)



The project site is a terraced valley in the Mediterranean coast, in the Iberian peninsula. This place is not a natural territory, but an anthropic landscape. In this part of Europe is not possible to understand nature without human hand.

The land and culture have evolved together for millennia, generating wealth and prosperity in the Mediterranean peoples.

#### TERRACES. DRYSTONE WALL >

Three generations build a dry stone wall to hold the terrain in this vineyard.



Although stone wall may seem a simple construction, it performs several interesting features. It functions as retaining walls for agricultural terraces **e 11-12-13'**. It drains stormwater and prevents erosion. **d 5-6-7'** It is built with stones taken from the fields. **a 15'** It allows animal shelters and growing plants inside its joints. Thus, it becomes a reliable biological corridor between the fields. **b 1'** In short, it is an essential element of the cultural landscape. **c**

\*The numbers found in the description refer to the points of analysis according to the method proposed by VerSus.

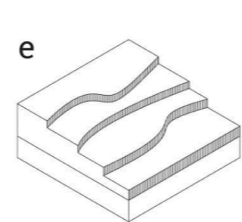
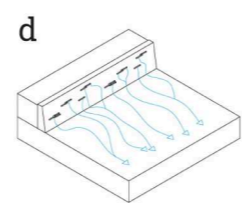
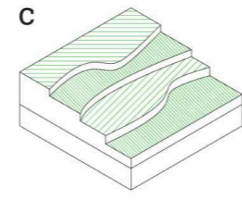
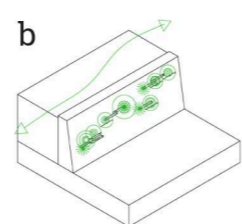
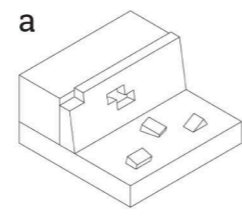

#### MASONRY HUTS >

Masonry huts nearby the project site.



The "Masonry huts" are part of the most archaic heritage of the Mediterranean, with infinite variations. **i 8'** Formerly they serve as protection shelter for agriculture and livestock activities, and currently they are used as a family meeting place. **j 10'** They were built resting on the dry stone walls that separate parcels. With an immediate relation to the fields. **h 2-4'** They were constructed with stones extracted to making the field cultivable, and with nearby material like pinewood and reeds. **f 3-13-14-15'** The "casetas" are often built with precise orientation, with the entrance facing south and protected from the north. **g 2-4'**.

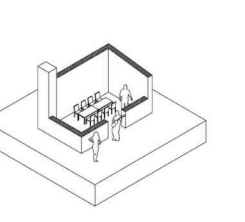
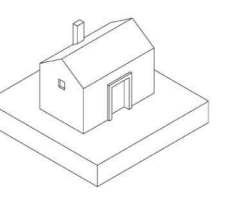
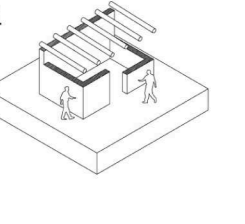
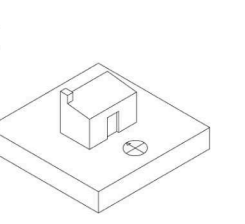
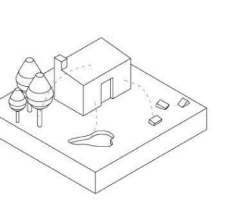

#### COUNTRYHOUSE >

Countryhouse nearby the project site.



The "Casas de Labor" are compact groups of buildings, arising in rainfed areas and linked to water resources. They are usually surrounded by various agricultural buildings like barnyards and threshing floor. **2-4'** Currently the "Casas de Labor" in the area are all deprecated, due to improved communications and services offered by small urban agglomerations. In the past, they formed a network of territorial colonization and transformation. Its construction was carried out with nearby material **3-13-14-15'**.

\*The numbers found in the description refer to the points of analysis according to the method proposed by VerSus.

#### PROPOSAL IMPLANTATION scale:1/2000

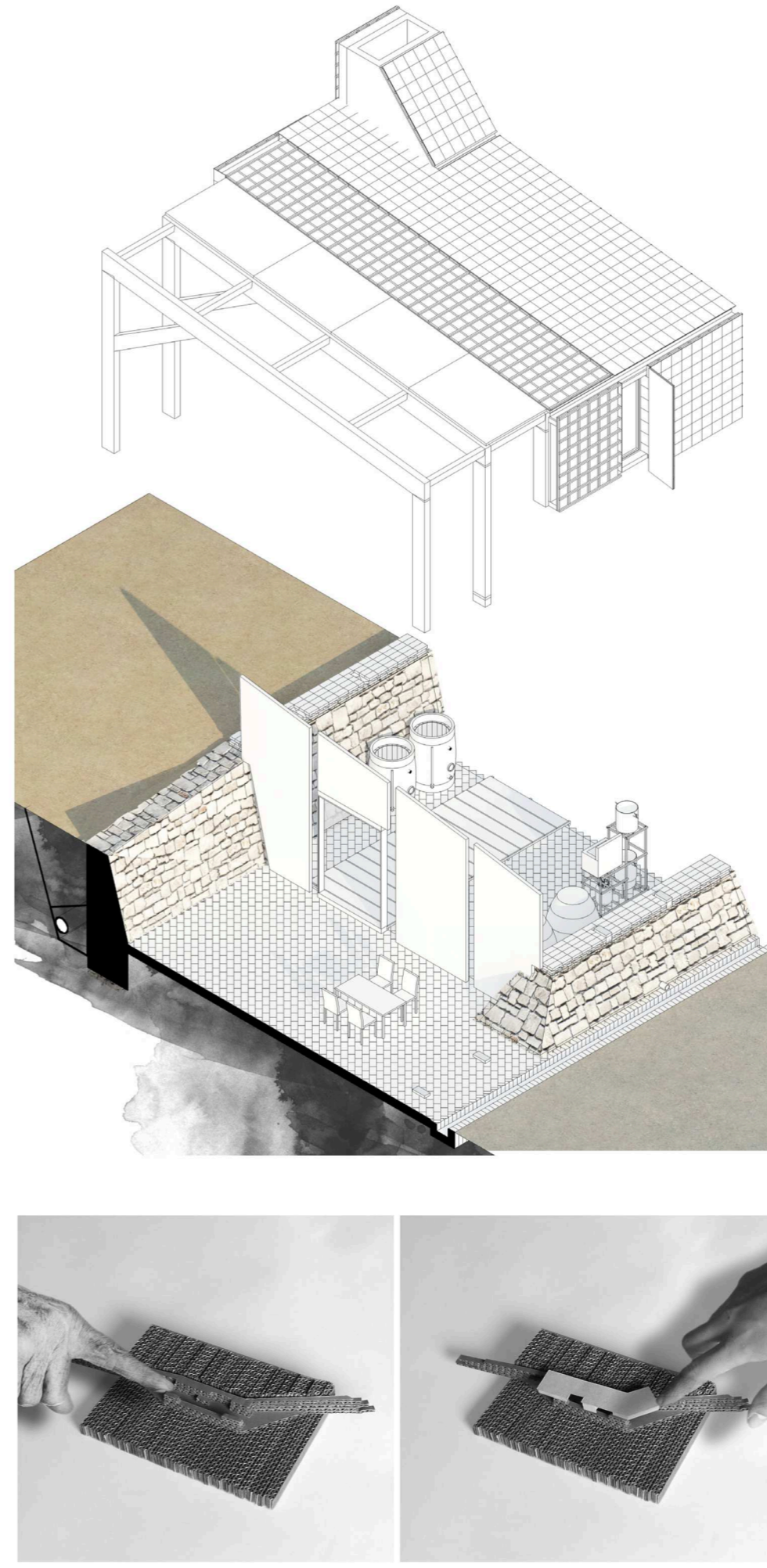

#### CONTEMPORARY RURAL SETTLEMENT

The current situation of socio-economic instability is leading to a paradigm shift. Many young people no longer consider cities as places of opportunity, and are coming back to the countryside looking for a future.

But coming back to the countryside should be worth. and based on a conception of life and the economy beyond the quantifiable, This project is a consideration on how should be a contemporary rural settlement.

This project is based on three strategies:

#### I. STROKES RESPECT

The project is implemented as a new layer of time, the next line of a story being carved in the territory for more than 500 years.

The most important traces in this place are the limits of the territory, especially roads and the terraces. The new settlement emphasizes these lines, assimilates the language and proposes a distribution that does not break with the internal rules of geometry generation. An analysis of the work of Pablo Palazuelo is made to generate compositions departing from the existing and proposing the next logical state.

The project spans within the territory, embracing the different fields (each with a different use) and generating new terraces where slope permits. The intervention has an agricultural character, and is dissolved in the territory.

#### II. PRODUCTIVE FIELDS

There is a majority-held belief that cultivating the field involves going against the species that inhabit it. Of course, it is harmful if the way to grow is extensive and exhausts all soil wealth. But if man is able to settle in a responsible manner, he can generate artificial or man-made habitats of great ecological value.

The settlement will preserve the countryside keeping it productive. It will follow organic and biodynamic farming principles.

#### III. MATERIALITY CONSTRAINT

Approach the country culture does not mean that our proposal has to be anachronistic. Instead, we must find the balance by adding our "layer of time".

The cross section can be understood as the interaction of two distinct technologies:

The first (tectonic) is heir to the tradition and related to the land where it is inserted, retains the patterns and the way of build of the place.

The second (stereotomic) shows the spirit of the time, drastic changes experienced by our generation. A global, technical and fast construction.

#### GENERAL SECTION AA' e:1/2000

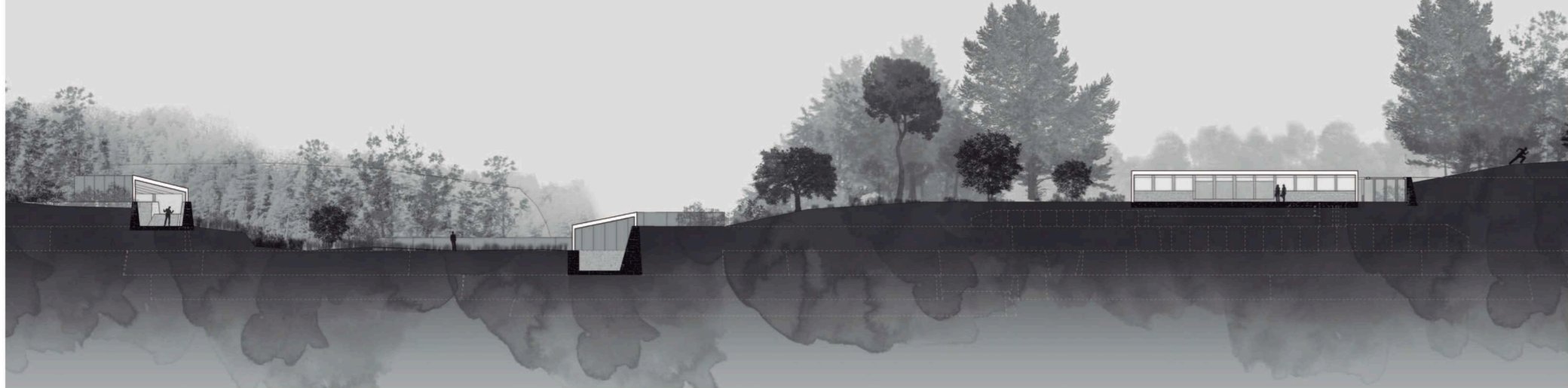

#### GENERAL SECTION BB' e:1/2000



#### FIELDS LAYOUT



#### BUILDING LAYOUT



1. Facilities. Production and storage of electricity. Deposit and purified water/ 2. Biodynamic preparations store/ 3. Oven and pottery/ 4. Vine processing/ 5. Stored and bottled/ 6. Nursery garden/ 7. Product warehouse/ 8. Brewery/ 9. Office and sales/ 10. Contemplative space, cottage rehabilitation/ 11. Events/ 12. Compost/ 13. Farm animal/ 14. Individual lodging/ 15. Shared lodging/ 16. Single family lodging

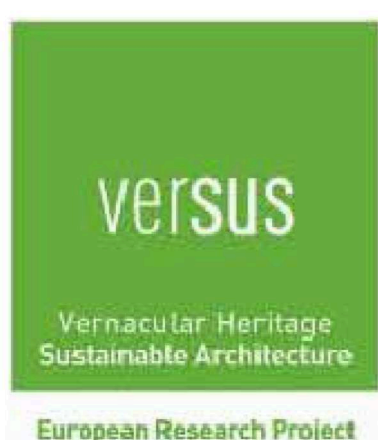

Project Leader



Partners



With the support of the Culture Programme of the European Union

